

SSS-48

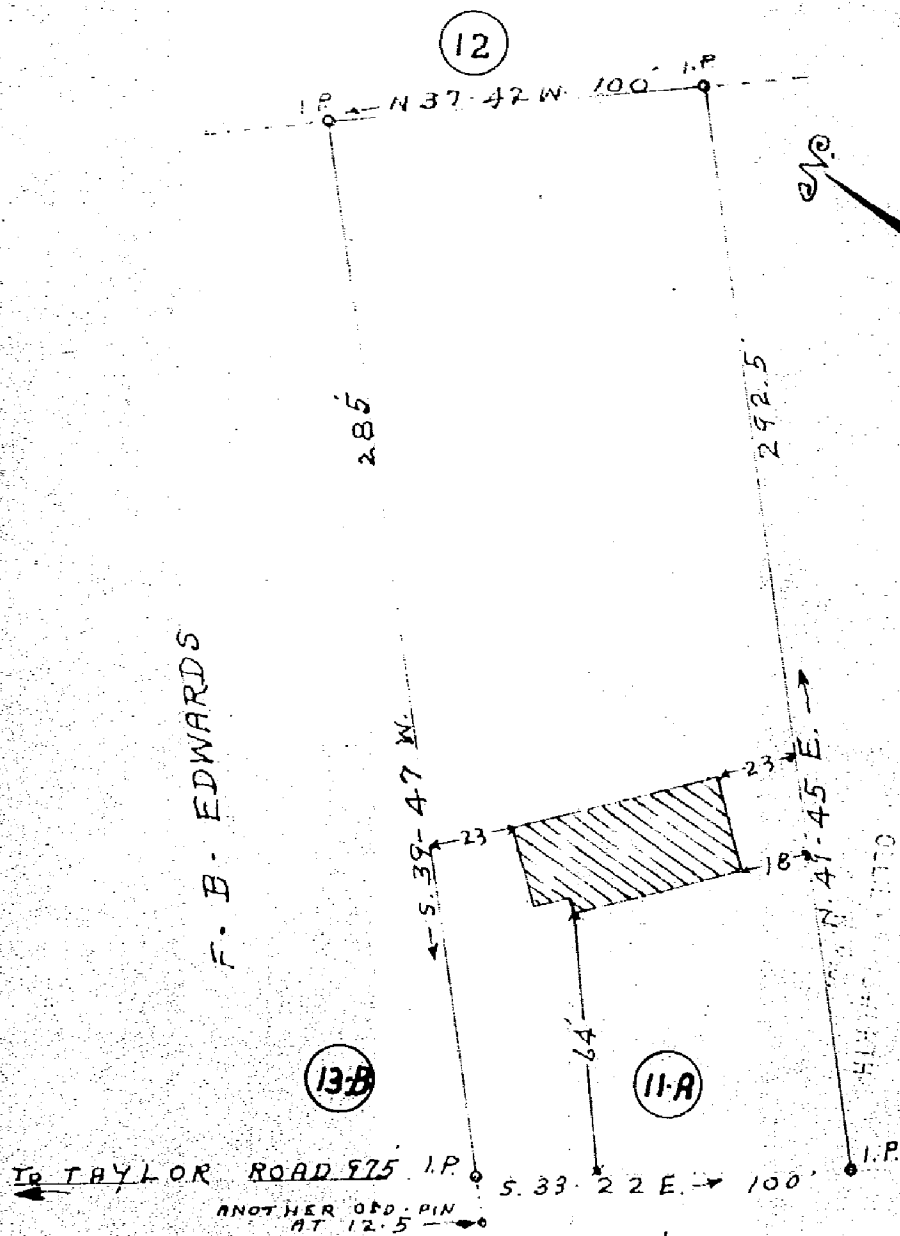

MAR 20 2 45 P.M. 1968  
 GREENVILLE COUNTY S.C.  
 REC'D

MEMORIAL DRIVE EXTENSION

PROPERTY OF  
**JAMES T. & BARBARA K. HALL**  
 LOCATED NEAR GREER  
 GNICK SPRINGS TOWNSHIP GREENVILLE COUNTY  
**SOUTH CAROLINA**

SCALE: 1" = 50 FEET MARCH 16 1968

*[Faint, mostly illegible text, likely a survey description or notes.]*

MAR 20 1968

SSS-48

24545

H. S. Brockman

100 photo